

Clamping Devices "actima" EH 23260.



Product Description

The compact clamping element can be converted between pull and push clamping strain, depending on the model. The travel path is 10 mm. Within the short clamp travel of 2 mm, self-locking occurs in any position. The maximum permitted clamping force is 4.9 kN.

Material

Housing

- Thermoplastic, black

Body

- Steel, blackened

Ball knob

- DIN 7708 - thermosetting plastic (PF 31), red similar to RAL 3003

Accessories

- Steel, blackened

Drawing

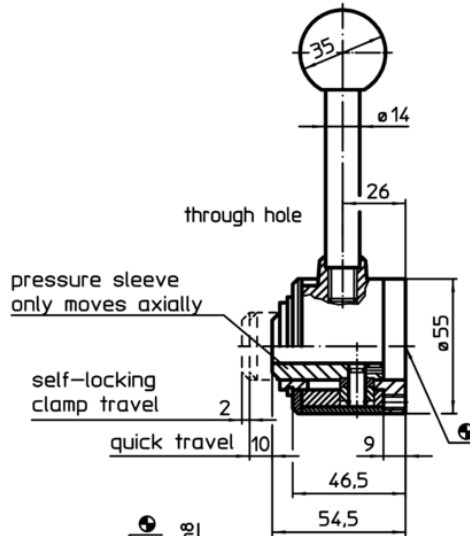
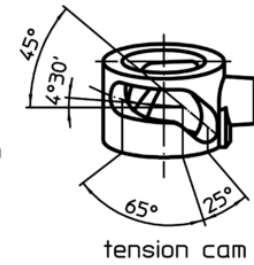
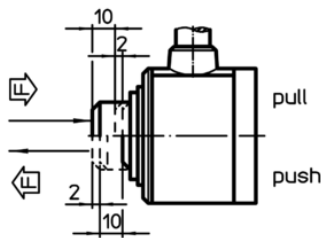
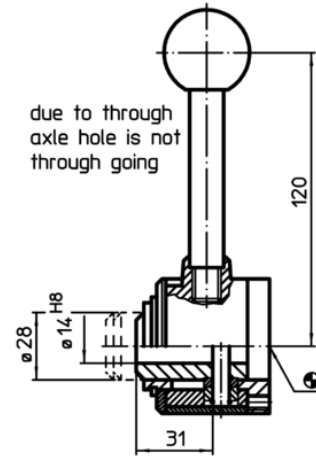
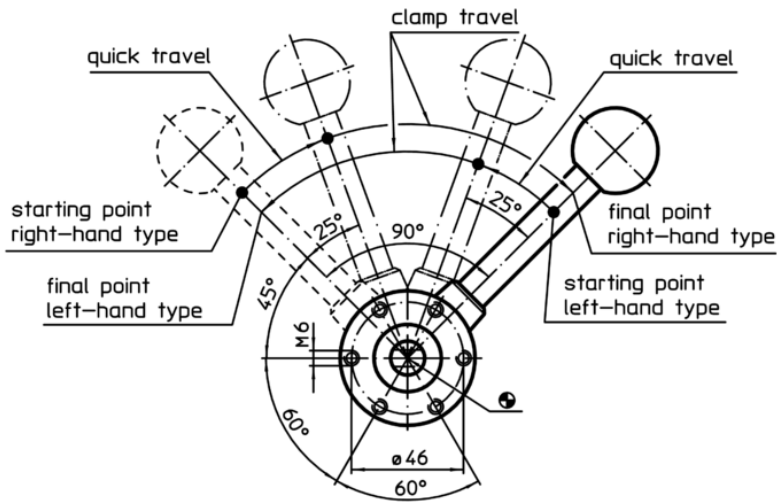

accessories

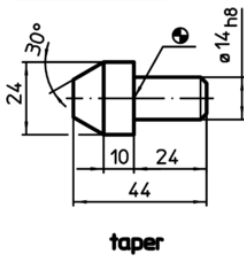

taper

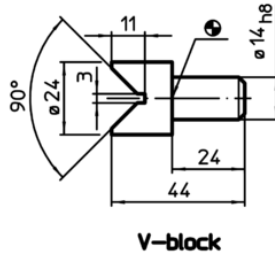

V-block

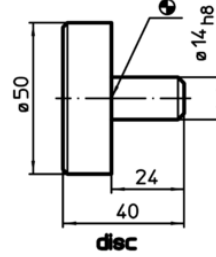

disc

Order information

Travel path [mm]	s Clamping way [mm]	Clamping force max. [kN]	 [g]	RoHS	REACH	Art. No.
pull to right, with transverse axis in the bore						
10	2	4.9	751	RoHS-compliant	contains no SVHC materials	23260.0003
pull to left, with transverse axis in the bore						
10	2	4.9	749	RoHS-compliant	contains no SVHC materials	23260.0005
pull to right, with throughgoing bore						
10	2	4.9	745	RoHS-compliant	contains no SVHC materials	23260.0013
pull to left, with throughgoing bore						
10	2	4.9	750	RoHS-compliant	contains no SVHC materials	23260.0015
push to right, with transverse axis in the bore						
10	2	4.9	751	RoHS-compliant	contains no SVHC materials	23260.0002
push to left, with transverse axis in the bore						
10	2	4.9	749	RoHS-compliant	contains no SVHC materials	23260.0004
push to right, with throughgoing bore						
10	2	4.9	745	RoHS-compliant	contains no SVHC materials	23260.0012
push to left, with throughgoing bore						
10	2	4.9	750	RoHS-compliant	contains no SVHC materials	23260.0014

Accessories

 [g]	Art. No.
disc	
270	23260.0042
taper	
85	23260.0044
V-block	
82	23260.0046

Application example

