

Fulcrum Pins
23400.0085



Product Description

Material

- Fulcrum Pins
- Stainless steel 1.4021, heat-treated
- Safety ring
- Stainless steel 1.4310

More information

References

Suitable for eccentric levers EH 23390. and similar applications.

Drawing

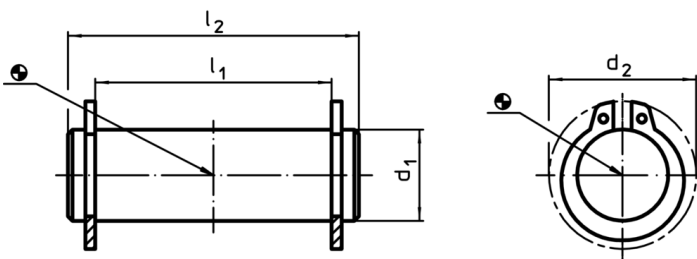

Order information

Dimensions		d ₂	l ₂	[g]	RoHS	REACH	Art. No.
d ₁	l ₁						
f8	-0.5	[mm]					
8	21	14.7	27	12	RoHS-compliant	contains no SVHC materials	23400.0085

Application example

